

STATE PROJECT REFERENCE NO.	SHEET NO.	TOTAL SHEETS
2021CPT.11.06.10861	1	8

STATE OF NORTH CAROLINA
DIVISION OF HIGHWAYS

SURRY COUNTY

**LOCATION: US 52 FROM STOKES COUNTY LINE
TO SR 1815 (COOK SCHOOL ROAD)**

**TYPE OF WORK: MILLING, RESURFACING
AND SHOULDER RECONSTRUCTION**

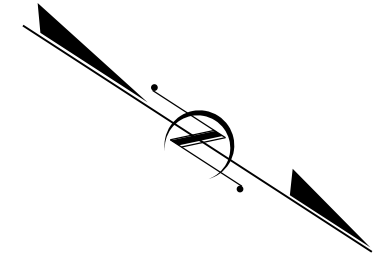
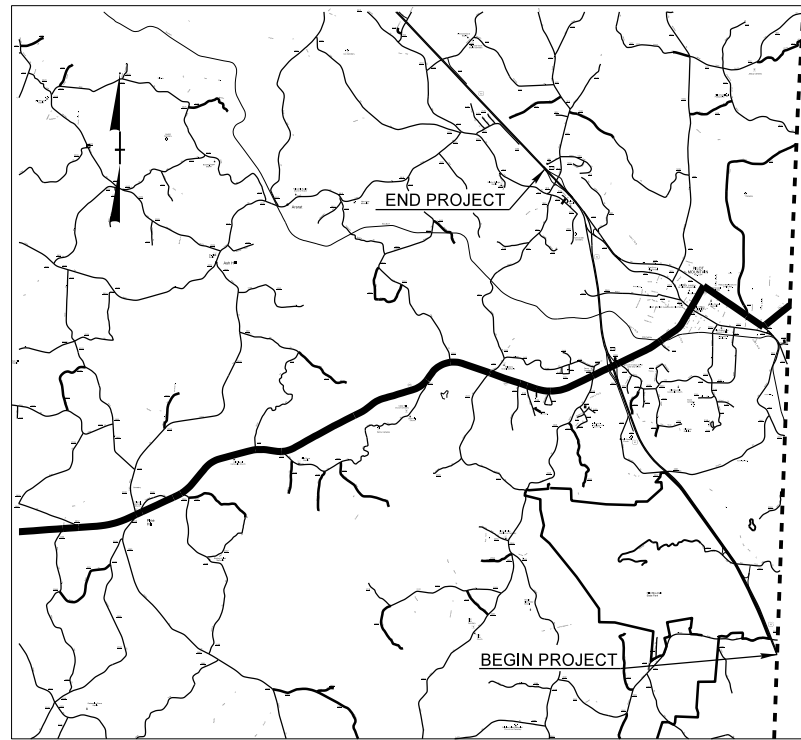

TIP PROJECT:

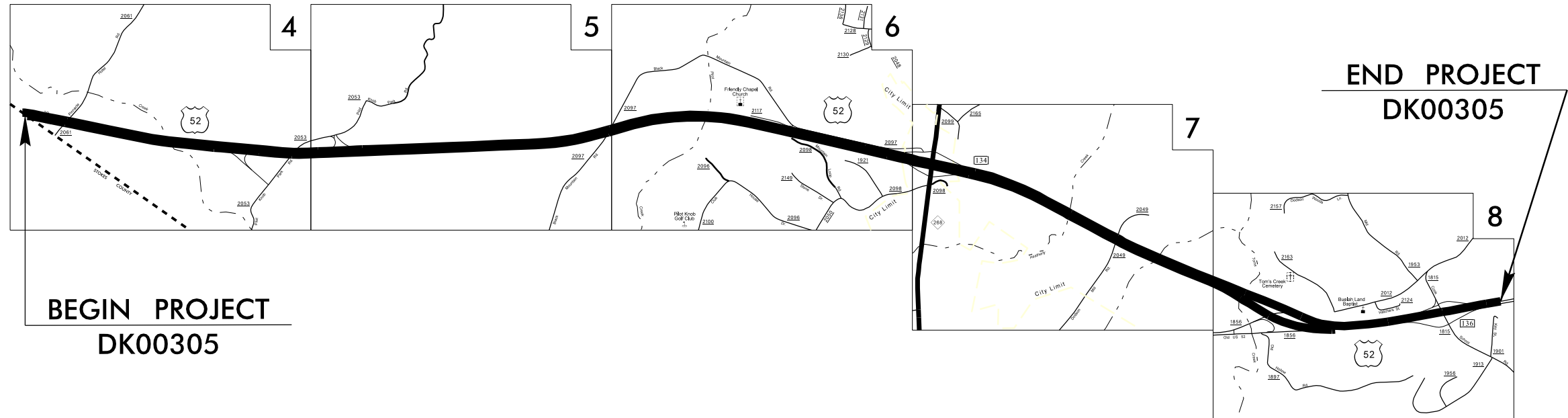

CONTRACT: DK00305

Prepared in the Office of:
DIVISION OF HIGHWAYS
801 STATESVILLE ROAD, NORTH WILKESBORO, NC 28659

2018 STANDARD SPECIFICATIONS	
RIGHT OF WAY DATE: N/A	RAMIE A. SHAW, PE DIVISION PROJECT MANAGER
LETTING DATE: JUNE 17, 2021	MICHAEL A. PETTYJOHN, PE DIVISION ENGINEER

DIVISION OF HIGHWAYS
STATE OF NORTH CAROLINA

P.E.
STATE HIGHWAY DESIGN ENGINEER

17-MAY-2021 11:46 R:\2021 Resurfacing Maps\Surry\DK00305_US52-2021\DK00305-ddc_tsh_01.dgn \$\$\$USERNAME\$\$\$

6/2/99

24-MAY-2021 13:44
 R:\2021\Resurfacing Maps\Surry\DK00305_US52-2021\DK00305_ddc_typ_02_revised_052421.dgn
 \$\$\$\$USFENSLR\$\$\$\$

"PATCHING EXISTING PAVEMENT" HAS BEEN INCLUDED AS A PAY ITEM ON MAPS 1 AND 2 FOR SHOULDERS ONLY. PATCHING MAY OR MAY NOT BE NEEDED DEPENDING ON CONDITION OF MAP SURFACE AT TIME THAT PAVING SEASON BEGINS. AREAS TO BE DELINIATED BY THE ENGINEER.

INCIDENTAL MILLING IN LOCATIONS AS DIRECTED BY ENGINEER

PAVEMENT SCHEDULE	
C1	PROP. APPROX. 1½" ASPHALT CONCRETE SURFACE COURSE, TYPE S9.5C, AT AN AVERAGE RATE OF 168 LBS. PER SQ. YD.
T	SHOULDER RECONSTRUCTION
U1	EXISTING CONCRETE PAVEMENT
U2	EXISTING ASPHALT PAVEMENT
U3	EXISTING BRIDGE DECK
Y	MILLED RUMBLE STRIPS

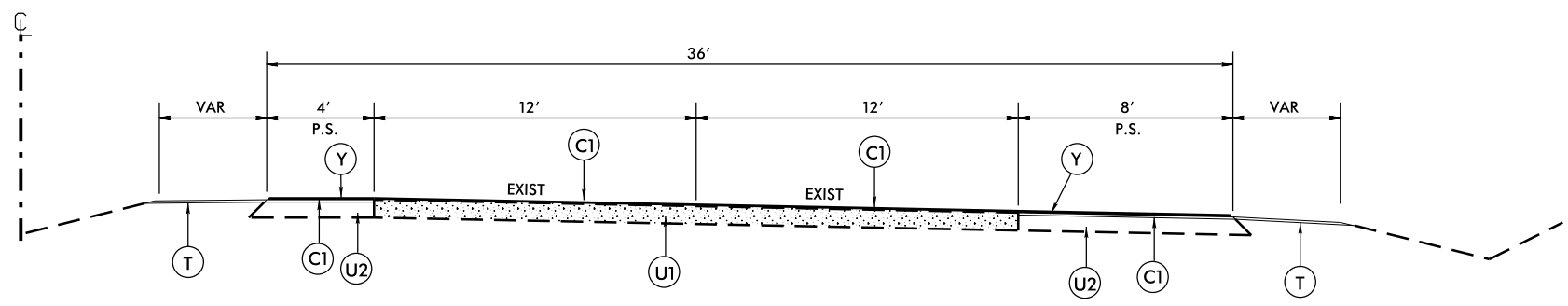

TYPICAL SECTION NO. 1

MAP #1 – US 52 NBL – FROM STOKES COUNTY LINE (MP 0.00) TO EXISTING RESURFACING JOINT AT SR 1856 ON RAMP GORE (MP 5.89)

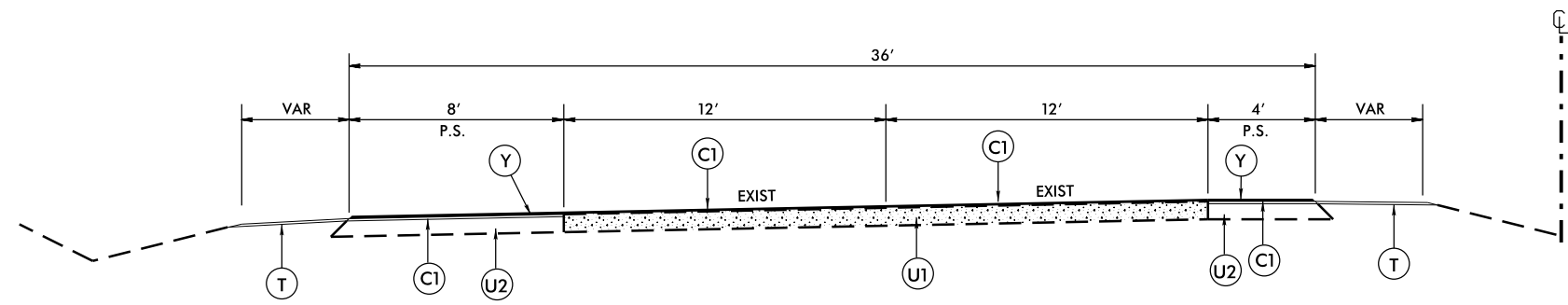

TYPICAL SECTION NO. 2

MAP #2 – US 52 SBL – FROM BEGIN SR 1815 SB OFF RAMP TAPER (MP 14.03) TO STOKES COUNTY LINE, 0.18 MI. S OF BR#16 (MP 20.76)

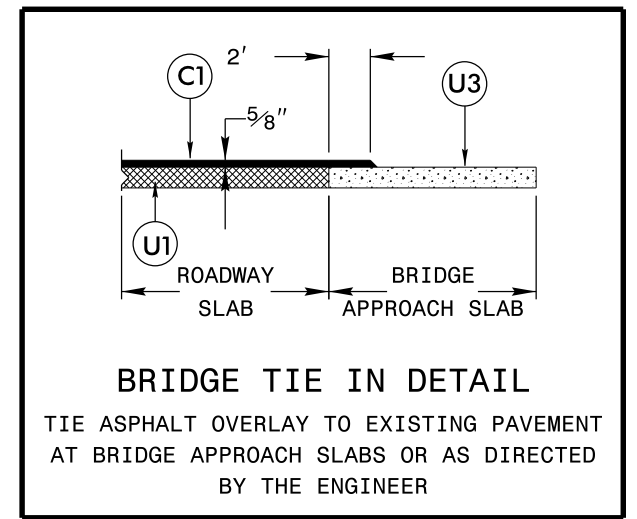

SURRY COUNTY PRIMARY ROADS 2021 ASPHALT RESURFACING		
DIVISION II SURRY COUNTY		
REVISIONS	INIT.	DATE
N.C. DEPARTMENT of TRANSPORTATION DIVISION of HIGHWAYS DIVISION ELEVEN		SCALE: N/A DATE: 5/24/2021 PREPARED BY: GKirby REVIEWED BY: REVIEWED BY:

6/2/99

24-MAY-2021 13:47
 R:\2021\Resurfacing Maps\Surry\DK00305_US52-2021\DK00305_ddc_typ_02_revised.dgn
 \$\$\$\$USFENB\$\$\$

INCIDENTAL MILLING IN LOCATIONS AS DIRECTED BY ENGINEER

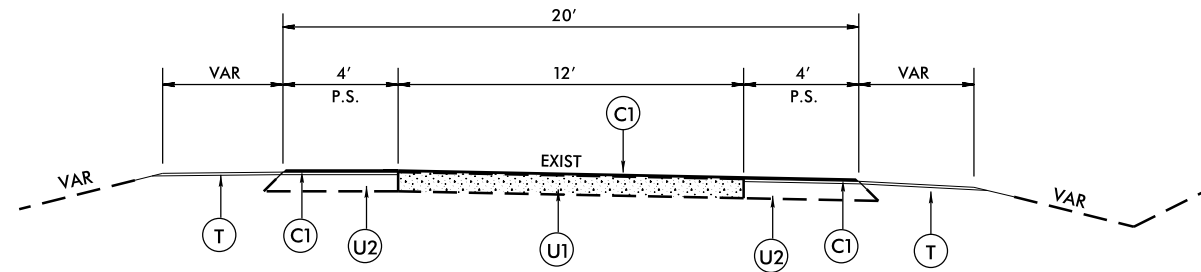

TYPICAL SECTION NO. 3

- MAP #3 – RAMP 2759 FROM US 52 NB TO BEGIN CONCRETE ISLAND (0.19 MI)
- MAP #4 – RAMP 2758 FROM END CONCRETE ISLAND TO US 52 NB (0.14 MI)
- MAP #5 – RAMP 2753 US 52 NB TO EXISTING RESURFACING JOINT AT NC 268 ROUND ABOUT (0.18 MI)
- MAP #6 – RAMP 2754 FROM EXISTING RESURFACING JOINT AT NC 268 ROUND ABOUT TO US 52 NB (0.19 MI)
- MAP #7 – SR 1856 NB FROM EXISTING RESURFACING JOINT, 0.10 MI N OF 1897 TO US 52 NB ON RAMP GORE (0.13 MI)
- MAP #8 – RAMP 2744 FROM US52 SB TO EXISTING RESURFACING JOINT AT SR 1815 (0.19 MI)
- MAP #9 – RAMP 2746 FROM EXISTING RESURFACING JOINT AT SR 1815 TO US 52 SB (0.25 MI)
- MAP #10 – SR 1856 SB FROM US 52 SB TO BR#328 (0.31 MI)
- MAP #11 – RAMP 2751 FROM US 52 SB TO EXISTING RESURFACING JOINT AT NC 268 ROUND ABOUT (0.20 MI)
- MAP #12 – RAMP 2752 FROM EXISTING RESURFACING JOINT AT NC 268 ROUND ABOUT /SR 2097 TO US 52 SB (0.25 MI)
- MAP #13 – RAMP 2755 FROM US 52 SB TO SR 2053 (0.18 MI)
- MAP #14 – RAMP 2756 FROM SR 2053 TO US 52 SB (0.13 MI)
- MAP #15 – RAMP 2757 FROM SR 2053 TO RAMP 2756 (0.02 MI)

PAVEMENT SCHEDULE	
C1	PROP. APPROX. 1½" ASPHALT CONCRETE SURFACE COURSE, TYPE S9.5C, AT AN AVERAGE RATE OF 168 LBS. PER SQ. YD.
T	SHOULDER RECONSTRUCTION
U1	EXISTING CONCRETE PAVEMENT
U2	EXISTING ASPHALT PAVEMENT
U3	EXISTING BRIDGE DECK
Y	MILLED RUMBLE STRIPS

SURRY COUNTY PRIMARY ROADS 2021 ASPHALT RESURFACING		
DIVISION II SURRY COUNTY		
REVISIONS	INIT.	DATE
N.C. DEPARTMENT of TRANSPORTATION DIVISION of HIGHWAYS DIVISION ELEVEN		SCALE: N/A DATE: 5/24/2021 PREPARED BY: GKirby REVIEWED BY:

PROJECT NO.	SHEET NO.	TOTAL NO.
2021CPT.11.06.10861	3	

SUMMARY OF QUANTITIES

Project No.	County	Map No.	Route	Route Name	From Description	To Description	Mile Post From	Mile Post To	TYP NO	LANES	LENGTH		BORROW	SHOULDER RECONSTRUCTION	INCIDENTAL MILLING	SURFACE COURSE, S9.5C	ASPHALT BINDER FOR PLANT MIX	PATCHING EXISTING ASPHALT	MILLED RUMBLE STRIPS	SEED & MULCHING								
											MI	FT									CY	SMI	SY	TON	TON	TON	LF	AC
2021CPT.11.06.10861	Surry	1	US 52 NBL	US 52 NB	Stokes Co Line	Existing Resurfacing Joint at SR 1856 On Ramp Gore	0.00	5.89	1	2	5.89	39	1,178	11.78	4,785	12,230	734	1,223	62,198	4.28								
2021CPT.11.06.10861	Surry	2	US 52 SBL	US 52 SB	Begin SR 1815 SB Off Ramp Taper	Stokes Co Line	14.03	20.76	2	2	6.73	39	1,346	13.46	3,920	13,974	838	1,397	71,069	4.89								
2021CPT.11.06.10861	Surry	3	RAMP 2759	RAMP 2759	US 52 NB	Begin Concrete Island	0.00	0.19	3	1	0.19	25	38	0.38	140	253	15			0.14								
2021CPT.11.06.10861	Surry	4	RAMP 2758	RAMP 2758	End Concrete Island	US 52 NB	0.15	0.29	3	1	0.14	25	28	0.28	140	186	11			0.10								
2021CPT.11.06.10861	Surry	5	RAMP 2753	RAMP 2753	US 52 NB	Existing Resurfacing Joint at NC 268 Roundabout	0.00	0.18	3	1	0.18	25	36	0.36	140	240	14			0.13								
2021CPT.11.06.10861	Surry	6	RAMP 2754	RAMP 2754	Existing Resurfacing Joint at NC 268 Roundabout	US 52 NB	0.04	0.23	3	1	0.19	22	38	0.38	125	223	13			0.14								
2021CPT.11.06.10861	Surry	7	SR 1856 NB	SR 1856 NB	Existing Resurfacing Joint, .10 mi N of SR 1897	US 52 NB On Ramp Gore	1.60	1.73	3	1	0.13	22	26	0.26	125	152	9			0.09								
2021CPT.11.06.10861	Surry	8	RAMP 2744	RAMP 2744	US 52 SB	Existing Resurfacing Joint at SR 1815	0.00	0.19	3	1	0.19	22	38	0.38	125	223	13			0.14								
2021CPT.11.06.10861	Surry	9	RAMP 2746	RAMP 2746	Existing Resurfacing Joint at SR 1815	US 52 SB	0.02	0.27	3	1	0.25	25	50	0.50	140	333	20			0.18								
2021CPT.11.06.10861	Surry	10	SR 1856 SB	SR 1856 SB	US 52 SB	BR# 328	0.00	0.31	3	1	0.31	30	62	0.62	170	495	30			0.23								
2021CPT.11.06.10861	Surry	11	RAMP 2751	RAMP 2751	US 52 SB	Existing Resurfacing Joint at NC 268 Roundabout	0.00	0.20	3	1	0.20	22	40	0.40	125	234	14			0.15								
2021CPT.11.06.10861	Surry	12	RAMP 2752	RAMP 2752	Existing Resurfacing Joint at NC 268 Roundabout/SR 2097	US 52 SB	0.06	0.31	3	1	0.25	25	50	0.50	140	333	20			0.18								
2021CPT.11.06.10861	Surry	13	RAMP 2755	RAMP 2755	US 52 SB	SR 2053	0.00	0.18	3	1	0.18	25	36	0.36	140	240	14			0.13								
2021CPT.11.06.10861	Surry	14	RAMP 2756	RAMP 2756	SR 2053	US 52 SB	0.00	0.13	3	1	0.13	22	26	0.26	125	152	9			0.09								
2021CPT.11.06.10861	Surry	15	RAMP 2757	RAMP 2757	SR 2053	RAMP 2756	0.00	0.02	3	1	0.02	25	4	0.04	140	27	2			0.01								
TOTAL FOR PROJECT NO. 2021CPT.11.06.10861											14.98		2,996	29.96	10,480	29,293	1,758	2,620	133,267	10.89								

For 'Mile Post' information, visit ncdot.maps.arcgis.com, then select 'NCDOT Distance Hatches & Structures Map'

PROJECT NO.	SHEET NO.	TOTAL NO.
2021CPT.11.06.10861	3-A	

THERMOPLASTIC AND PAINT QUANTITIES

Project No.	County	Map No.	Route	Route Name	From Description	To Description	Mile Post From	Mile Post To	TYP NO	LANES	LENGTH		WIDTH		4413000000-E	4457000000-N	4815000000-E		4825000000-E	4845000000-N		4905000000-N	5255000000-N
											MI	FT	WORK ZONE ADVANCE/GENERAL WARNING SIGNING	TEMPORARY TRAFFIC CONTROL	6" WHITE PAINT	6" YELLOW PAINT	12" WHITE PAINT	PAINT WRONG WAY RAMP ARROW	PAINT MERGE ARROW	SNOW PLOWABLE MARKERS	PORTABLE LIGHTING		
											SF	LS	LF	LF	LF	EA	EA	EA	LS				
2021CPT.11.06.10861	Surry	1	US 52 NBL	US 52 NB	Stokes Co Line	Existing Resurfacing Joint at SR 1856 On Ramp Gore	0.00	5.89	1	2	5.89	39			1,531	1	93,298	62,198	3,400		12	389	1
2021CPT.11.06.10861	Surry	2	US 52 SBL	US 52 SB	Begin SR 1815 SB Off Ramp Taper	Stokes Co Line, .18 mi S of BR# 16	14.03	20.76	2	2	6.73	39			1,750		106,603	71,069	5,770		18	444	
2021CPT.11.06.10861	Surry	3	RAMP 2759	RAMP 2759	US 52 NB	Begin Concrete Island	0.00	0.19	3	1	0.19	25			25		2,006	2,006					
2021CPT.11.06.10861	Surry	4	RAMP 2758	RAMP 2758	End Concrete Island	US 52 NB	0.15	0.29	3	1	0.14	25			18		1,478	1,478					
2021CPT.11.06.10861	Surry	5	RAMP 2753	RAMP 2753	US 52 NB	Existing Resurfacing Joint at NC 268 Roundabout	0.00	0.18	3	1	0.18	25			23		1,901	1,901		2		14	
2021CPT.11.06.10861	Surry	6	RAMP 2754	RAMP 2754	Existing Resurfacing Joint at NC 268 Roundabout	US 52 NB	0.04	0.23	3	1	0.19	22			25		2,006	2,006					
2021CPT.11.06.10861	Surry	7	SR 1856 NB	SR 1856 NB	Existing Resurfacing Joint, .10 mi N of SR 1897	US 52 NB On Ramp Gore	1.60	1.73	3	1	0.13	22			17		1,373	1,373					
2021CPT.11.06.10861	Surry	8	RAMP 2744	RAMP 2744	US 52 SB	Existing Resurfacing Joint at SR 1815	0.00	0.19	3	1	0.19	22			25		2,006	2,006		2		14	
2021CPT.11.06.10861	Surry	9	RAMP 2746	RAMP 2746	Existing Resurfacing Joint at SR 1815	US 52 SB	0.02	0.27	3	1	0.25	25			33		2,640	2,640					
2021CPT.11.06.10861	Surry	10	SR 1856 SB	SR 1856 SB	US 52 SB	BR# 328	0.00	0.31	3	1	0.31	30			40		3,274	3,274					
2021CPT.11.06.10861	Surry	11	RAMP 2751	RAMP 2751	US 52 SB	Existing Resurfacing Joint at NC 268 Roundabout	0.00	0.20	3	1	0.20	22			26		2,112	2,112		2		14	
2021CPT.11.06.10861	Surry	12	RAMP 2752	RAMP 2752	Existing Resurfacing Joint at NC 268 Roundabout/SR 2097	US 52 SB	0.06	0.31	3	1	0.25	25			33		2,640	2,640					
2021CPT.11.06.10861	Surry	13	RAMP 2755	RAMP 2755	US 52 SB	SR 2053	0.00	0.18	3	1	0.18	25			23		1,901	1,901					
2021CPT.11.06.10861	Surry	14	RAMP 2756	RAMP 2756	SR 2053	US 52 SB	0.00	0.13	3	1	0.13	22			17		1,373	1,373					
2021CPT.11.06.10861	Surry	15	RAMP 2757	RAMP 2757	SR 2053	RAMP 2756	0.00	0.02	3	1	0.02	25			3		211	211					
TOTAL FOR PROJECT NO. 2021CPT.11.06.10861											14.98			3,588	1	224,822	158,189	9,170	6	30	875	1	
												383,011		36									

For 'Mile Post' information, visit ncdot.maps.arcgis.com, then select 'NCDOT Distance Hatches & Structures Map'

PROJECT REFERENCE NO. 2021CPT.JI.06.J086I	SHEET NO. 4
ROADWAY DESIGN ENGINEER	HYDRAULICS ENGINEER

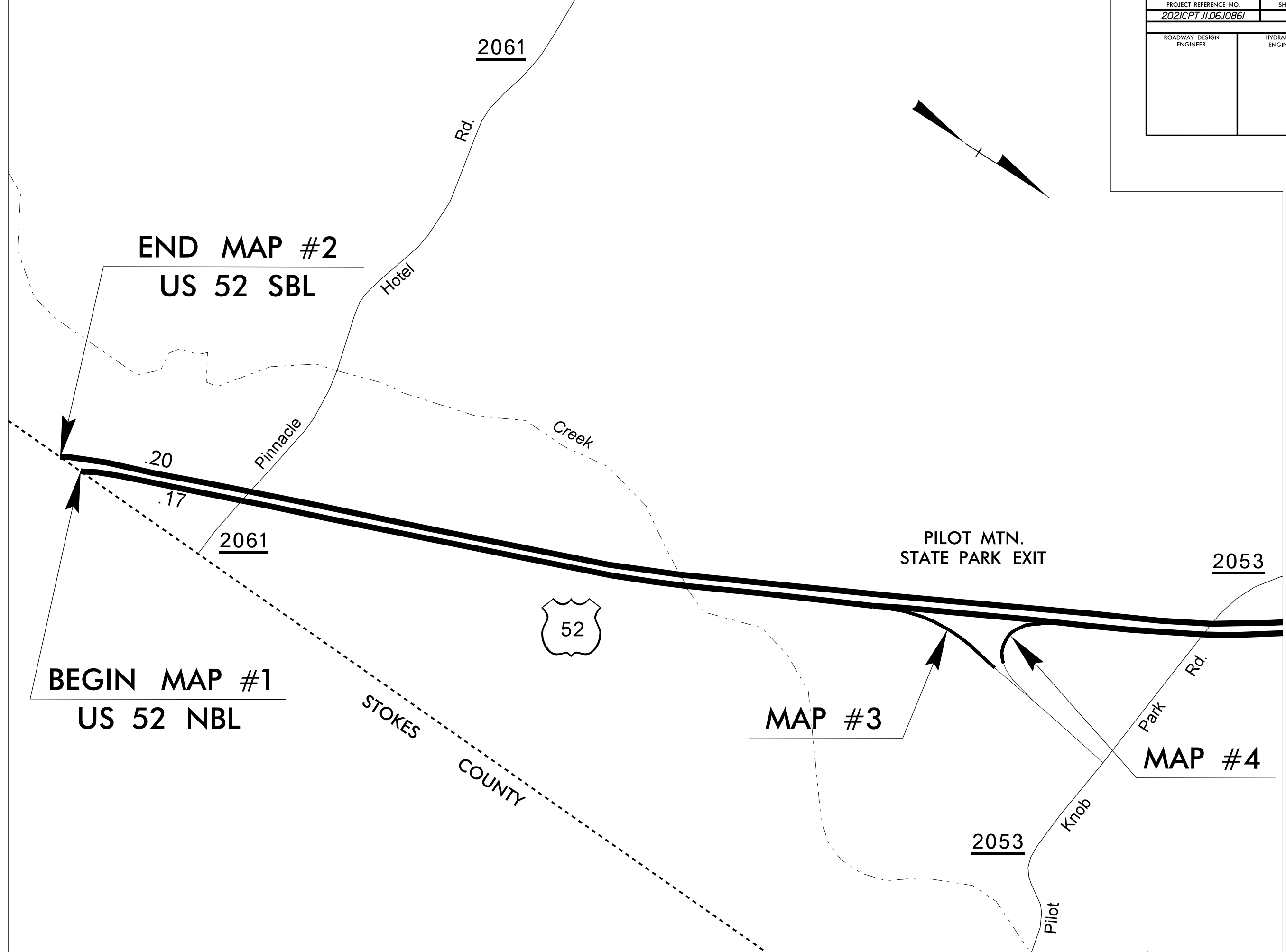

MATCHLINE * SEE SHEET 5 *

8/17/99

PROJECT REFERENCE NO. 2021CPT JI.06.J086I		SHEET NO. 5	
ROADWAY DESIGN ENGINEER		HYDRAULICS ENGINEER	

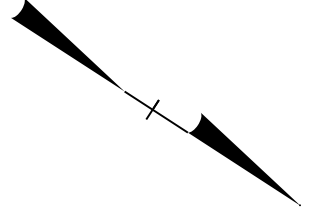

MATCHLINE * SEE SHEET 4 *

MATCHLINE * SEE SHEET 6 *

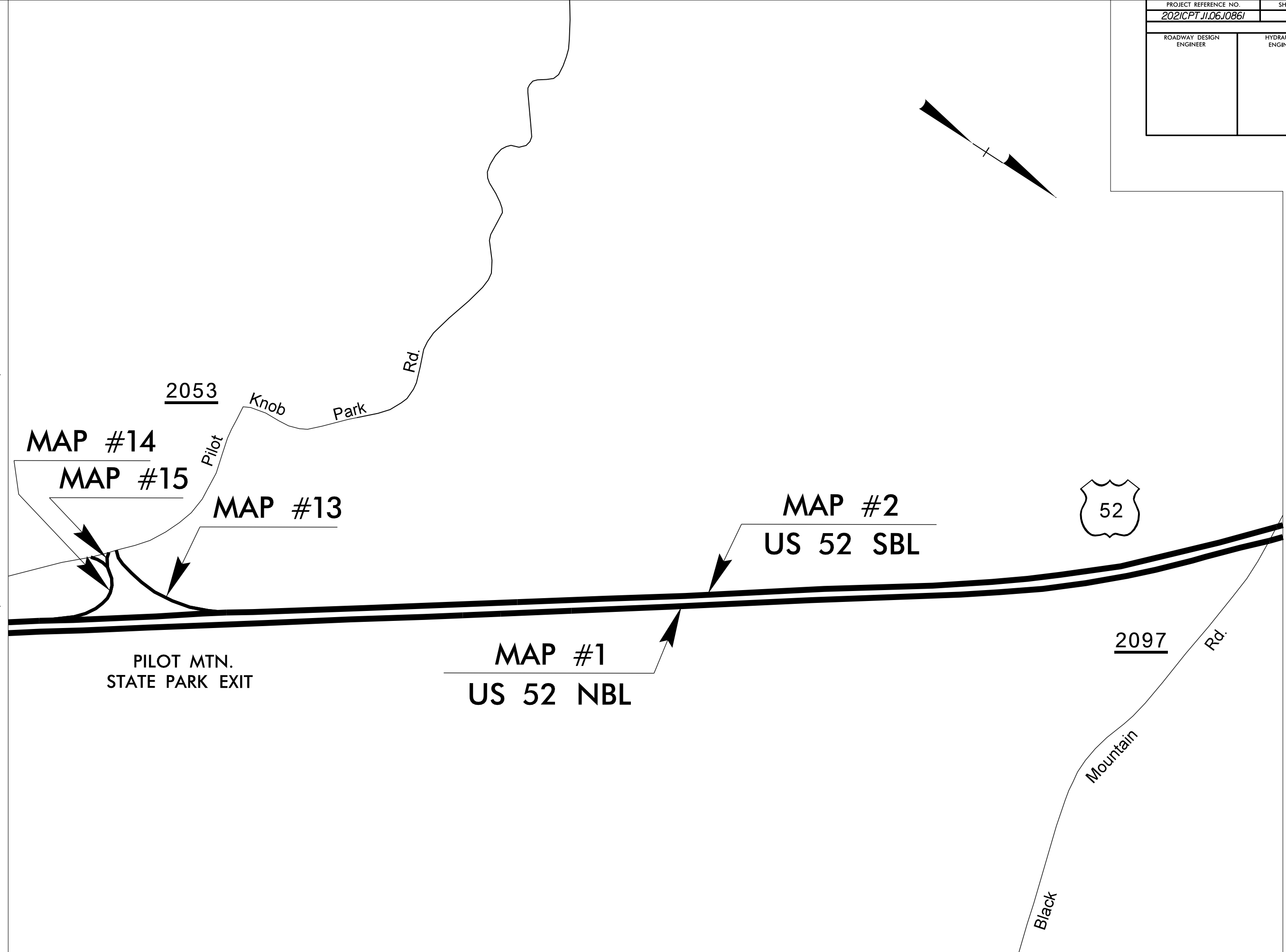

IT-MAY-2021\116
R:\2021\Resurfacing Maps\Surf\DK00305_US52-2021\DK00305.DOC_PSH06.dgn
8/17/99

PROJECT REFERENCE NO. 2021CPT.J1.06.J0861	SHEET NO. 6
ROADWAY DESIGN ENGINEER	HYDRAULICS ENGINEER

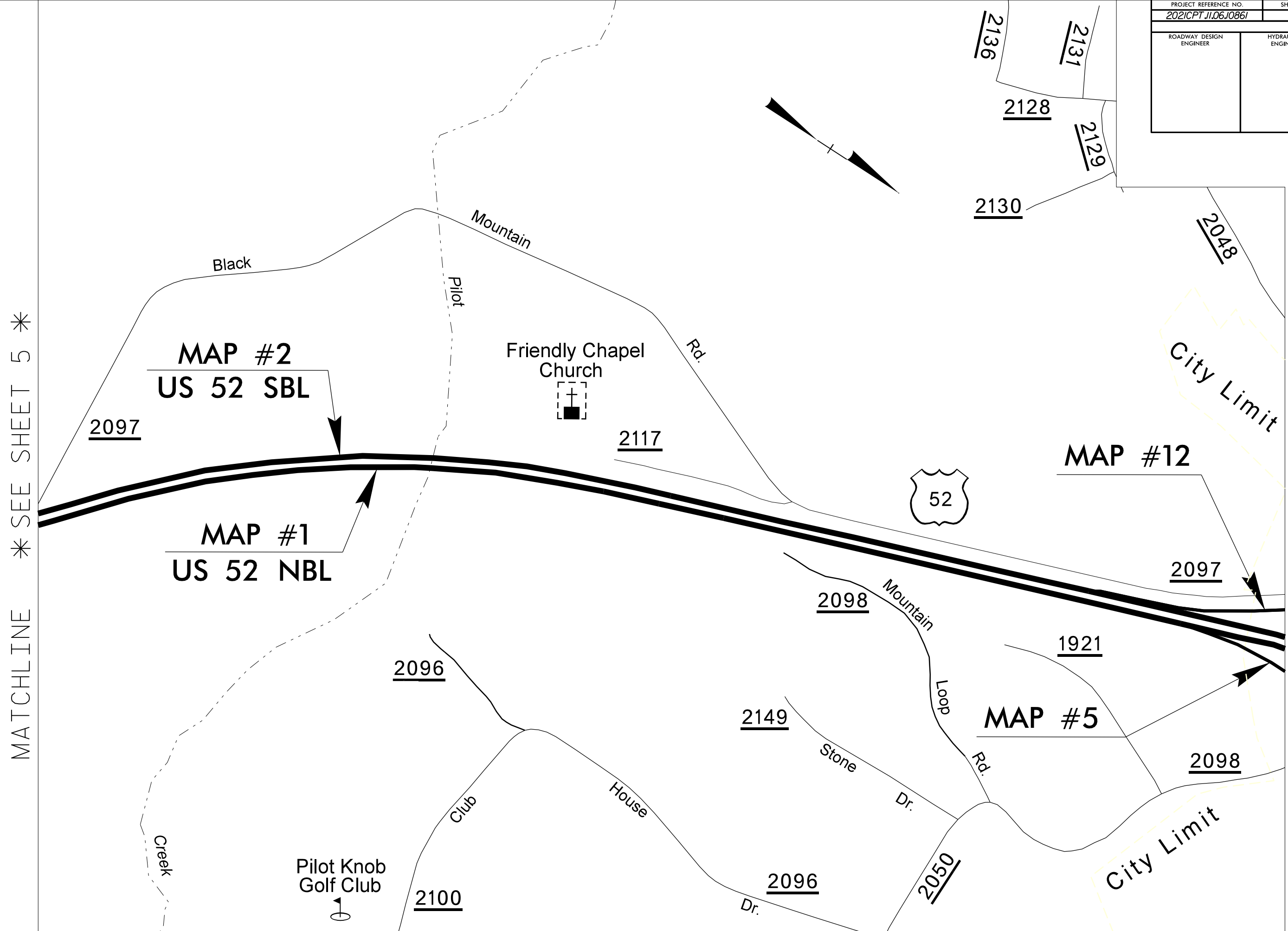

MATCHLINE * SEE SHEET 5 *

MATCHLINE * SEE SHEET 7 *

IT-MAY-2021\116
R:\2021\Resurfacing Maps\Surf\DK00305_US52-2021\DK00305.DOC_PSH07.dgn
8/17/99

PROJECT REFERENCE NO. 2021CPT.J1.06.J0861		SHEET NO. 7	
ROADWAY DESIGN ENGINEER		HYDRAULICS ENGINEER	

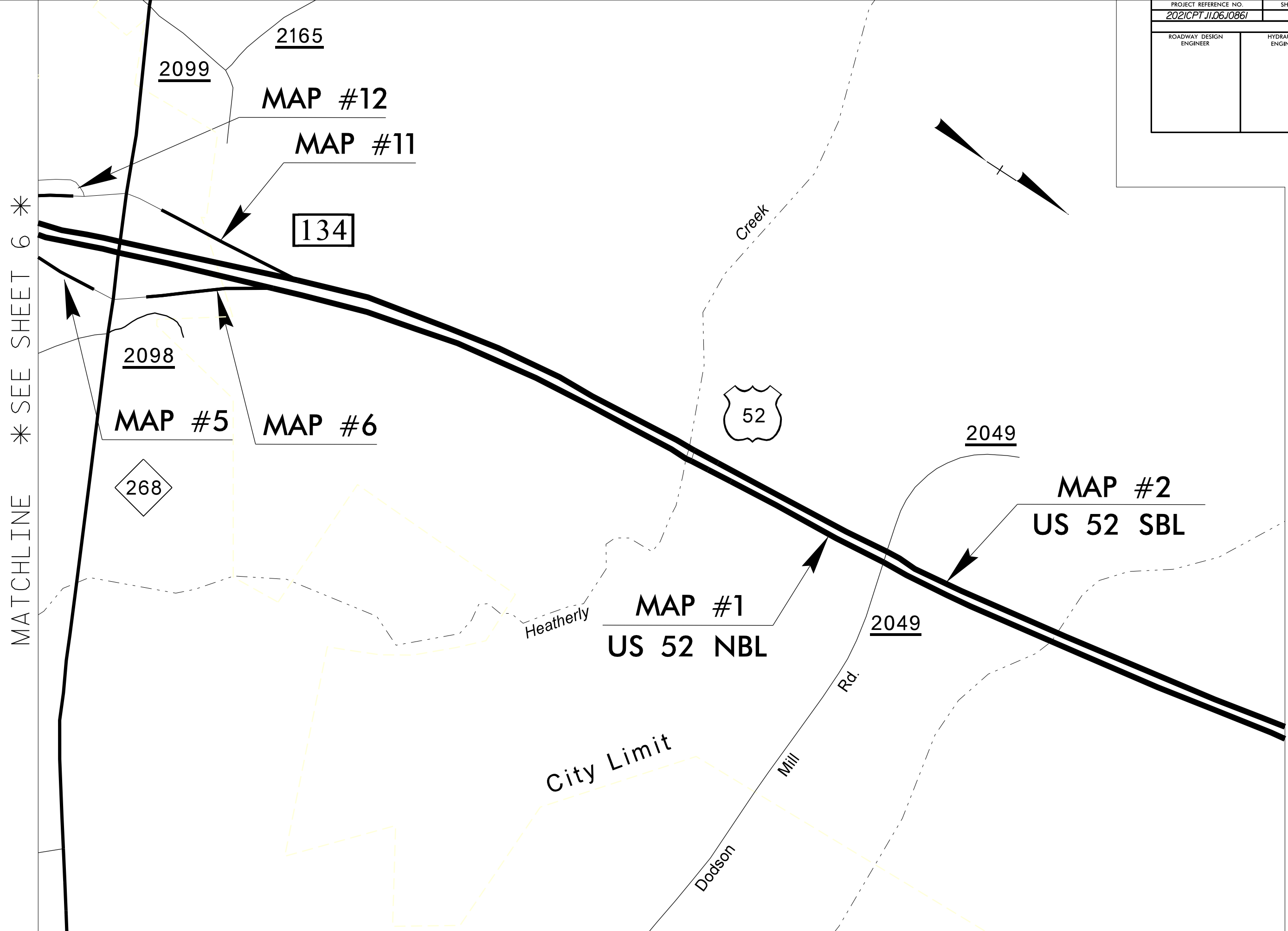

MATCHLINE * SEE SHEET 6 *

MATCHLINE * SEE SHEET 8 *

8/17/99
IT-MAY-2021\116
R:\2021\Resurfacing Maps\Surf\DK00305_US52-2021\DK00305.DDC_PSH05.dgn
\$\$\$\$\$

PROJECT REFERENCE NO. 2021CPT.J1.06.J0861	SHEET NO. 8
ROADWAY DESIGN ENGINEER	HYDRAULICS ENGINEER

MATCHLINE * SEE SHEET 7 *

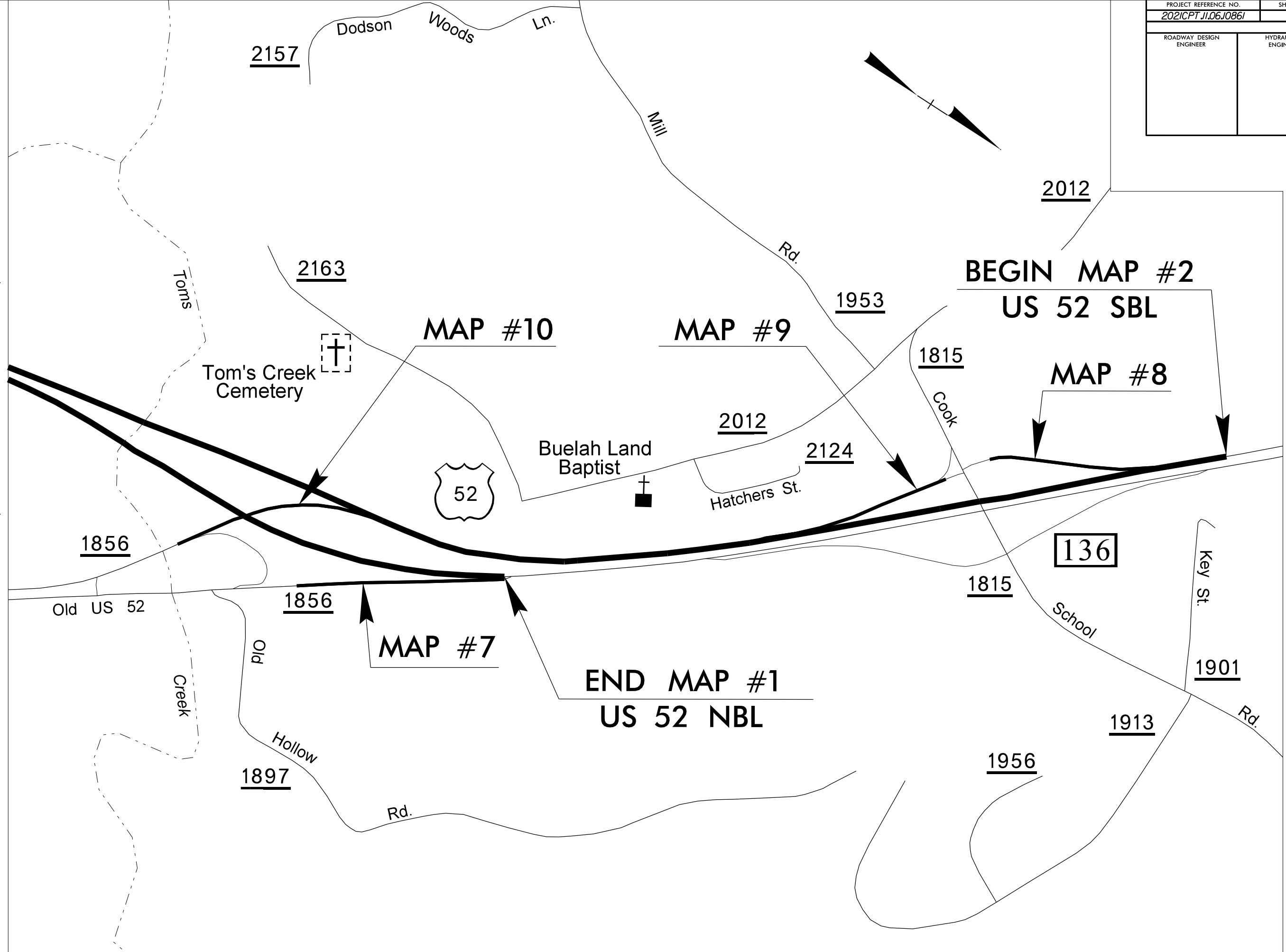

BEGIN MAP #2
US 52 SBL

MAP #8

MAP #9

MAP #10

MAP #7

END MAP #1
US 52 NBL

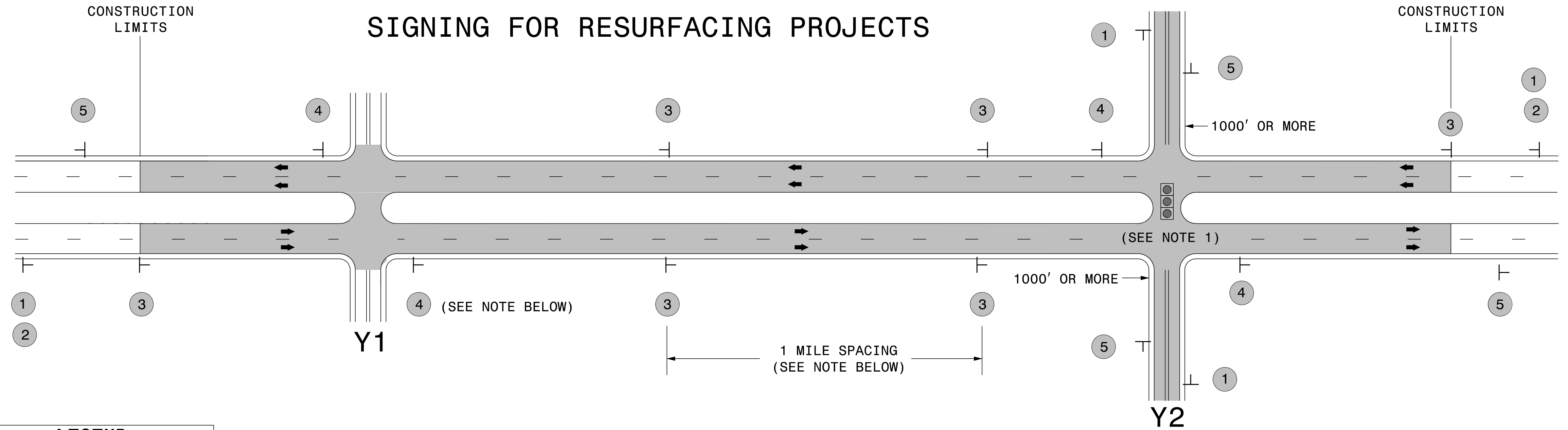

LEGEND
 ┆ STATIONARY SIGN
 ← DIRECTION OF TRAFFIC FLOW

MAINLINE (-L-) SIGNING

-Y- LINE SIGNING

SIGNING NOTES AND PLACEMENT PER DIRECTION	 	<p>PLACE 1000' PRIOR TO BEGINNING OF CONSTRUCTION LIMITS. ONLY USED ON -Y- LINES IF RESURFACING LIMITS EXTEND 1000' ALONG -Y- LINE.</p> <p>#2 SIGN ONLY USED WHEN RESURFACING LIMITS ARE 2 OR MORE MILES IN LENGTH. ROUND UP TO NEXT WHOLE NUMBER. (NO FRACTIONAL OR DECIMAL NUMBERS)</p>	<p>NO REQUIRED STATIONARY SIGNING FOR THE FOLLOWING -Y- LINE CONDITIONS:</p> <ol style="list-style-type: none"> 1) LESS THAN 1000' OF RESURFACING ALONG -Y- LINE 2) SUBDIVISION ROADS 3) DEAD END ROADS <p>WHEN PAVING/CONSTRUCTION ACTIVITIES PROCEED ACROSS AN UNSIGNED -Y- LINE, ADVANCE WARNING PORTABLE SIGNS SHALL BE USED ALONG THE -Y- LINE AS SHOWN BELOW. REMOVE UPON COMPLETION OF WORK.</p> <div style="display: flex; justify-content: space-around; align-items: center;"> <div style="text-align: center;"> <small>W20-1 48" X 48"</small> </div> <div style="text-align: center;"> <small>W20-7 A 48" X 48"</small> </div> </div> <p>PLACED 500' IN ADVANCE OF FLAGGER. PLACED 250' IN ADVANCE OF FLAGGER.</p> <p>NOTES:</p> <ol style="list-style-type: none"> 1) MAY USE LAW ENFORCEMENT TO CONTROL TRAFFIC AT SIGNALIZED INTERSECTIONS AS DIRECTED BY THE ENGINEER. PROVIDE PORTABLE "ROAD WORK AHEAD" (W20-1) SIGNS 500' IN ADVANCE ALONG BOTH APPROACHES FROM THE SIDE STREETS WHEN PAVING PROCEEDS THROUGH THE INTERSECTION.
		<p>PLACE INITIALLY AT THE CONSTRUCTION LIMITS AND SPACED 1 MILE APART THEREAFTER. IF NO -Y- LINES EXIST, PLACE 2ND SET 1/2 MILE FROM THE CONSTRUCTION LIMITS AND THEN SPACE 1 MILE THEREAFTER.</p>	
		<p>THESE ARE FOR -Y- LINES THAT ARE "THROUGH" ROADWAYS. DEAD END AND SUBDIVISION ROADS ARE NOT "THROUGH" ROADWAYS. INSTALL 500' +/- FROM EACH -Y- LINE APPROACH AS SHOWN ABOVE. FOR MULTIPLE -Y- LINES THAT ARE SEPARATED BY 0.25 MILES OR LESS, TREAT AS A SINGLE UNIT AND INSTALL WITHIN 500' OF EACH APPROACH. A MAXIMUM OF 2 SIGN SETS PER MILE. DO NOT INSTALL WHEN -Y- LINES ARE WITHIN 0.5 MILES FROM "END ROAD WORK" SIGN.</p>	
		<p>PLACE 500' FOLLOWING THE END OF CONSTRUCTION LIMITS.</p>	

3/23/2015
 C:\Users\rmgarrrett\Downloads\Resurfacing_AdvWarn_Lr-Su_Shldr.dgn
 User:rmgarrrett

**RESURFACING
ADVANCE WARNING SIGNS
FOR RURAL AND SUBURBAN
MULTI-LANE ROADWAYS
W/ SHOULDER SECTIONS**

- NOTES:
- 1) DETAIL DOES NOT APPLY TO OGAFB AND ULTRA-THIN BONDED WEARING COURSE.
 - 2) BACKFILL SHOULDER WITH APPROVED MATERIAL.
 - 3) THE SHOULDER WEDGE DEVICE MAY BE DISENGAGED AT PAVED DRIVEWAYS AND SIDE STREETS.

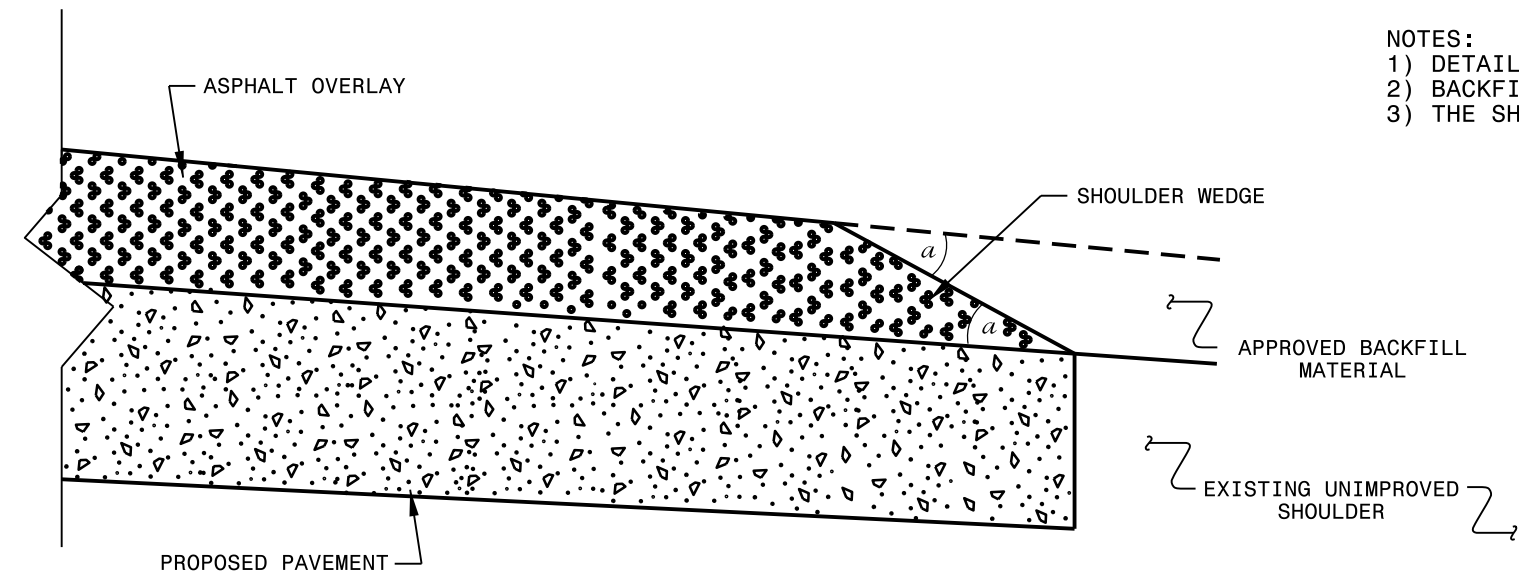

SHOULDER WEDGE DETAIL
 (Resurfacing Projects w/ Widening or
 with Existing Paved Shoulder having no dropoffs)

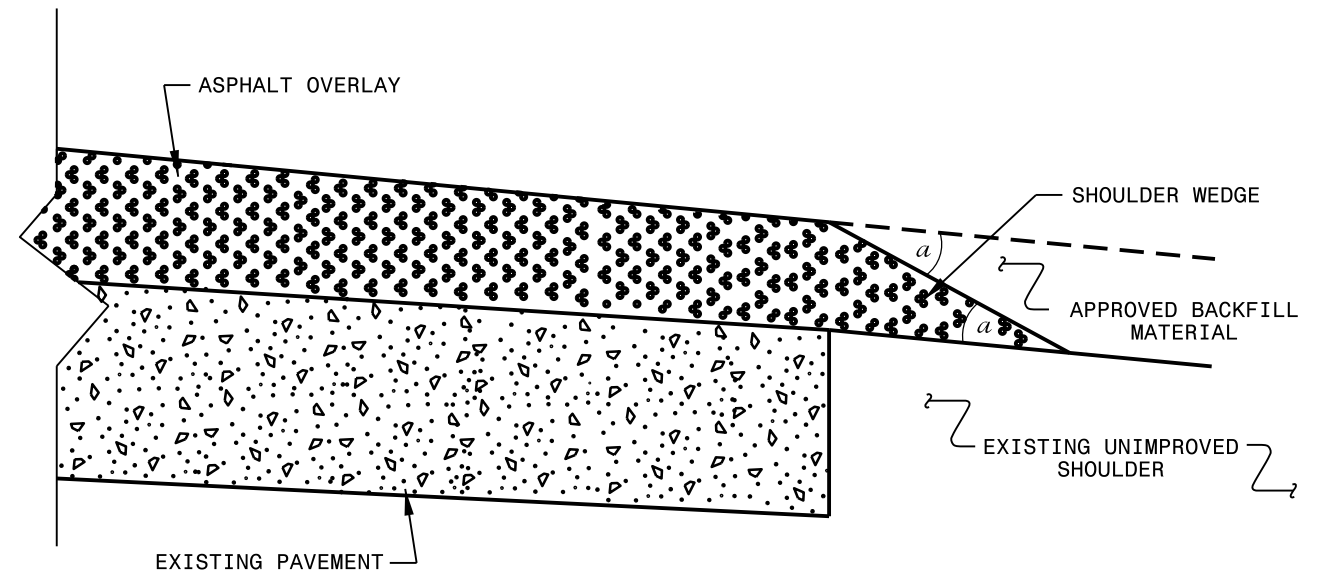

SHOULDER WEDGE DETAIL
 (Resurfacing Projects w/ NO Widening)

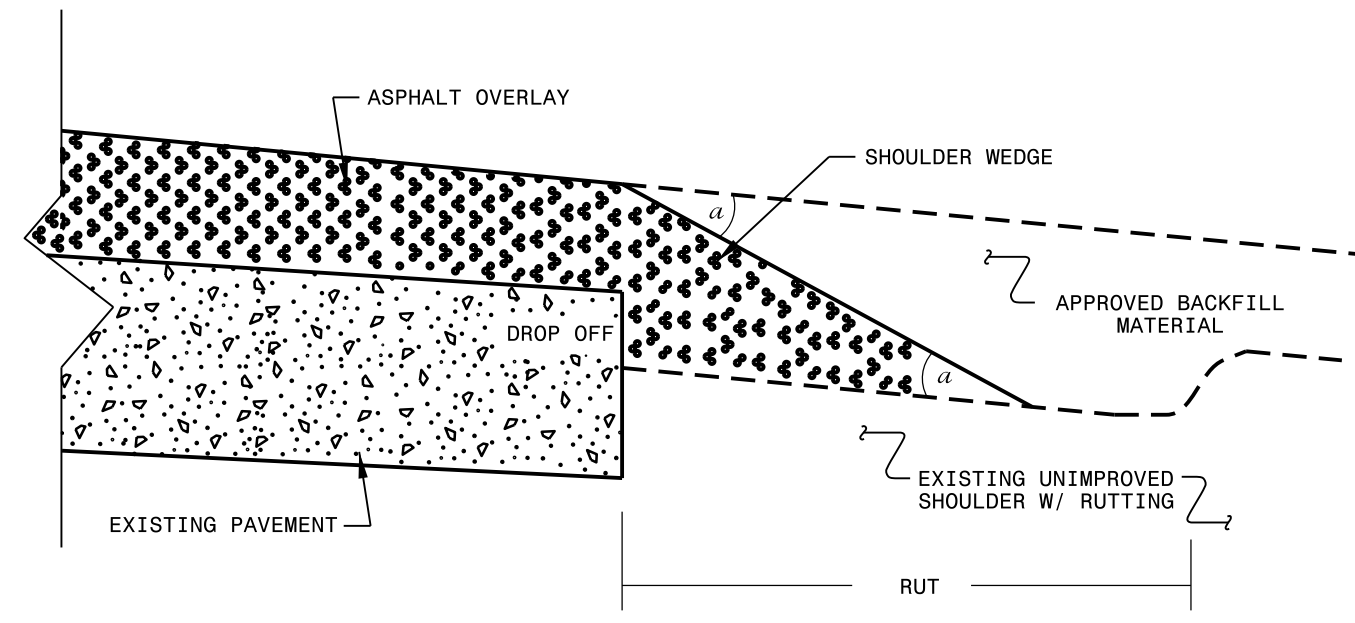

SHOULDER WEDGE DETAIL
 (Resurfacing Adjacent to
 Rutted Shoulder)

- SHOULDER WEDGE ANGLE = 30°

CONTRACT STANDARDS AND DEVELOPMENT UNIT			
Office 919-707-6950		FAX 919-250-4119	
SHOULDER WEDGE DETAILS			
ORIGINAL BY: T.SPELL	DATE: 7-19-11		
MODIFIED BY:	DATE: 10/16/12		
CHECKED BY:	DATE:		
FILE SPEC.: susr/details/stand/shoulderwedgedetail.dgn			

SYSTEMS DESIGN
 USER NAME